

SPINNING REEL — BW755

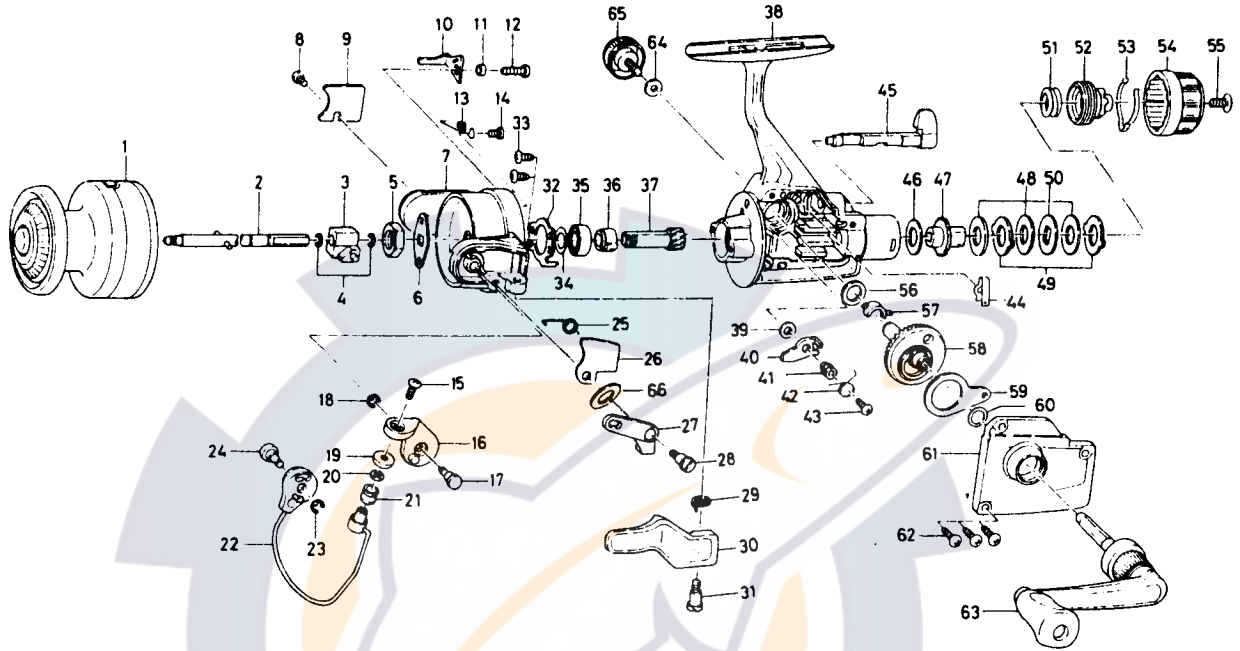

Key No.	Part No.	Part Name	Price	Key No.	Part No.	Part Name	Price
1	E09-8006	Spool assembly	6.50	34	B12-8701	Bearing washer	.30
2	E07-0101	Main shaft assembly	1.10	35	L90-4001	Ball bearing	6.60
3	B98-6501	Oscillating slider	.80	36	E04-5601	Anti-reverse ratchet	1.50
4	E04-0601	Oscillating slider retainer	.45	37	E03-6101	Pinion gear	2.75
5	342-4001	Rotor nut	.50	38	L90-4601	Body	6.20
6	E09-7601	Rotor nut holding plate	.45	39	E15-3101	Anti-reverse pawl washer	.30
7	L90-0302	Rotor	4.20	40	E03-2901	Anti-reverse pawl	.60
8	B93-3001	Bail trip cover screw	.45	41	E03-3001	Anti-reverse pawl collar	.55
9	E04-8402	Bail trip cover	.45	42	B95-9601	Anti-reverse pawl spring	.55
10	B59-1003	Bail trip lever	1.05	43	L01-1702	Anti-reverse pawl screw	.35
11	E05-3201	Bail trip lever collar	.40	44	B58-8601	Anti-reverse lever spring	.50
12	B93-3001	Bailtrip lever screw	.45	45	E03-2803	Anti-reverse lever	.90
13	B59-1201	Lever spring	.65	46	B58-9106	Drag washer A	.65
14	B96-7601	Lever spring screw	.40	47	E03-5102	Click gear	.60
15	352-2502	Line roller screw	.45	48	B58-9602	Drag washer B	.45
16	E04-5902	Bail arm	1.25	49	B58-9501	Eared washer	.50
17	E04-6001	Bail arm screw	.60	50	B58-9701	Key washer	.45
18	320-5901	Bail arm retainer	.50	51	B58-9801	Drag coil Spring	.60
19	B97-9801	Line roller collar	.50	52	E03-3101	Drag screw	.90
20	B55-4301	Line roller washer	.40	53	E03-3201	Drag washer spring	.50
21	250-3921	Line roller	.90	54	L90-0702	Drag knob	1.85
22	L90-1101	Bail	2.55	55	353-8203	Drag knob screw	.50
23	320-5901	Bail trip cam retainer	.50	56	E03-4501	Drive gear washer A	.40
24	E04-8602	Bail trip cam screw	.70	57	B96-0801	Drive gear collar	.60
25	L90-0601	Bail spring	.60	58	E03-6301	Drive gear	1.10
26	L90-0401	Bail spring cover	.60	59	481-1331	Oscillating slider	.95
27	E04-6202	Trigger plate	1.10	60	375-8508	Drive gear washer B	.35
28	E04-6301	Bail spring cover screw	.95	61	L90-4701	Side cover	2.75
29	L90-3801	Trigger spring	.60	62	B83-5002	Side cover screw	.60
30	E04-6404	Trigger lever	2.30	63	L90-1201	Handle assembly	6.05
31	E04-6301	Trigger screw	.95	64	B92-4901	Handle lock washer	.35
32	E15-0701	Bearing retainer	.95	65	E03-5501	Handle lock screw	.85
33	B93-3001	Bearing retainer screw	.45	66	373-1302	Bail spring washer	.60